

HALF FACE MASKS - DOUBLE FILTER

Article No.: 2840AV31
Model No.: AV-TP2000S

Half face mask with two filters is equipped with a silicone rubber oronasal in single size, an ergonomic harness with four couplings, provided with an head rest adaptable by the user connected to a supporting rigid part. The half mask comprises a frontal exhalation valve and two lateral inhalation valves fitted with special threaded connection mounting two AV-300 series filters, equipped with the same connection.



MATERIALS

AV-TP2000S half mask is made with the following materials:

- Mask body: Silicone rubber
- Rigid part: Polypropylene
- Exhalation valve holder: Plastic
- Filter holders: ABS
- Harness + head rest:
Elastic band + polypropylene
- Weight (without filters): 150 g

EN 140:1998 Performance Tests		EN 140	AV-TP 2000S
Total Inward Leakage (%)		> 2,0	1,0
Breathing resistance (mbar)	inhal. 30 l/min	< 0,5	0,2
	inhal. 95 l/min	< 1,3	0,5
	inhal. 160 l/min	< 2,0	1,1
	exhal. 160 l/min	< 3,0	2,6
CO2 content (%)		< 1,0	0,4

300 SERIES FILTERS

AVES® AV-TP2000S half mask is equipped with gas, particle and combined filters AV-300 series, with special threaded connection, directly screwed to the lateral filter holders. The field of application is different depending on the type of filter used: with particle filters the fields are for example pharmaceutical industry, chemical, building, foundry, agriculture, wood making and with gas and combined filters the fields are shipyard, aeronautics, painting, laboratory.

CERTIFICATION

AVES® AV-2000S half mask meets the requirements of EN 140:1998 European Standard and it has the CE Marking according to the European Directive 89/686/EEC, as a PPE of III Category. Italcert Srl (Notified Body n°0426) is the responsible of the certification (Art. 10) and of the final product control (Art. 11.B). The products are manufactured in a company that is ISO 9001:2008 certified.

** For the use limitation and all the other informations about the half mask, please refer to the User Information booklet enclosed to each half mask.



QUALITY
INNOVATION
FUNCTIONALITY

This Article Data Sheet (ADS) is designed and produced by FLOWTRONIX (FT) covered under the intellectual property law. Any reproduction in whole or in part is strictly prohibited without written approval. FT RP 4012-3.2

Doc. Control:	Rev.: 3.2	Date: April 6, 2016
---------------	-----------	---------------------



A PRODUCT OF

PROTECTIVE LINE

AVES[®]

HALF FACE MASKS - DOUBLE FILTER

Article No.: 2840AV31

Model No.: AV-TP2000S

TECHNICAL SPECIFICATIONS

The silicone rubber orinasal, certified FDA, avoids possible product contaminations. In order to ensure greater fit guarantee, the half mask uses the seal valves developed for the full face masks.



Flaps on the filter connector route the air flow to the entire filtering surface, increasing the efficiency and using the entire surface, increasing its economical value.



Support harness is attached to the rigid body of the half mask, not to the orinasal, therefore it does not mark the user's face and ensures a more uniform fit and comfort.



The flexible strap allow a simple and safe adjustment of the harness.

Vortex[™] technology



Balanced
Better distribution of weight on mask, better stability



Intuitive
Filter is easy to lock in thanks to thread connection



Airy
3 flaps on filter holders generate a lamellar air flow, reduce breathing resistance & increase filter life span



Resistant
Thread connection withstands time wear

K-omfort



Secure
Attached to a rigid frame, harness always fits perfectly



Non-marking
Once worn, it doesn't mark user's face



Balanced
Mask weight is conveyed evenly



Adjustable
4 (half masks) or 6 (full face masks) buckles for a more precise and comfortable adjustment



**QUALITY
INNOVATION
FUNCTIONALITY**

This Article Data Sheet (ADS) is designed and produced by FLOWTRONIX (FT) covered under the intellectual property law. Any reproduction in whole or in part is strictly prohibited without written approval. FT RP 4012-3.2

Doc. Control:	Rev.:	Date:
	3.2	April 6, 2016

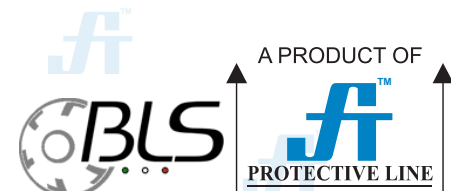



HALF FACE MASKS - DOUBLE FILTER

Article No.: 2840AV31

Model No.: AV-TP2000S

WEARING HALF FACE MASK

1. Screw the filters tightly onto the breathing apparatus, making sure that the rubber washer is in place at the base of the thread on the mask itself.

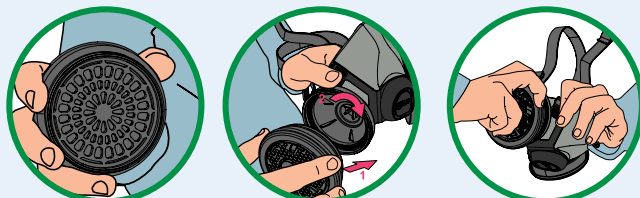

2. Slacken both harnesses to their maximum extent, then put your head into the harness, and place the half face mask over nose and mouth. With the other hand, position and tighten the harness on your head.



3. Adjust each harness strap individually to achieve a good fit of the mask to your face.



LEAK TEST

4. Press your palm against the filters for closing down the exit of the air. If trying to inspire you don't perceive air leaks between the face and the half mask, it means that the mask is well positioned and sealed.

Otherwise, we need a better placement on the face and possibly to increase the tension of the harness. Repeat the operation until you get a good seal.



CLEANING

5. The half face mask must be cleaned after each use. First remove the two filters, and blow dust from the mask. Use warm water containing a neutral detergent. Never use solvents. Disinfect with a normal disinfectant that will not damage plastic or rubber components. Dry rubber parts at a temperature below 50°C.

STORAGE

6. When storing the mask, hold in a closed packaging and make sure that it is protected by dust and dirt, light, humidity and heat.

** For the use limitation and all the other informations about the half mask, please refer to the User Information booklet enclosed to each half mask.



QUALITY
INNOVATION
FUNCTIONALITY

This Article Data Sheet (ADS) is designed and produced by FLOWTRONIX (FT) covered under the intellectual property law. Any reproduction in whole or in part is strictly prohibited without written approval. FT RP 4012-3.2

Doc. Control:	Rev.:	Date:
	3.2	April 6, 2016

